

bear

Estate Agents



Shorefield Road

Westcliff-on-Sea

£240,000



2



1



1

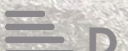

D

Shorefield Road



Description

A superb two bedroom second floor flat, situated within a block in a prominent position overlooking the seafront with views across the Thames Estuary. The flat has been beautifully presented throughout and benefits from two great sized bedrooms, a modern fitted kitchen and a spacious lounge/diner. The property also boasts off-street parking, communal gardens and comes with a share of the freehold.

- Second Floor Flat with a Share of Freehold
- Bay Fronted Lounge/Diner
- Two Double Bedrooms
- Three Piece Bathroom
- Communal Gardens
- Spacious Entrance Hall with Storage
- Modern Fitted Kitchen
- Built-in Storage to Bedroom Two
- Off-Street Parking Space
- Prime Westcliff-on-Sea Location





Floor Plan

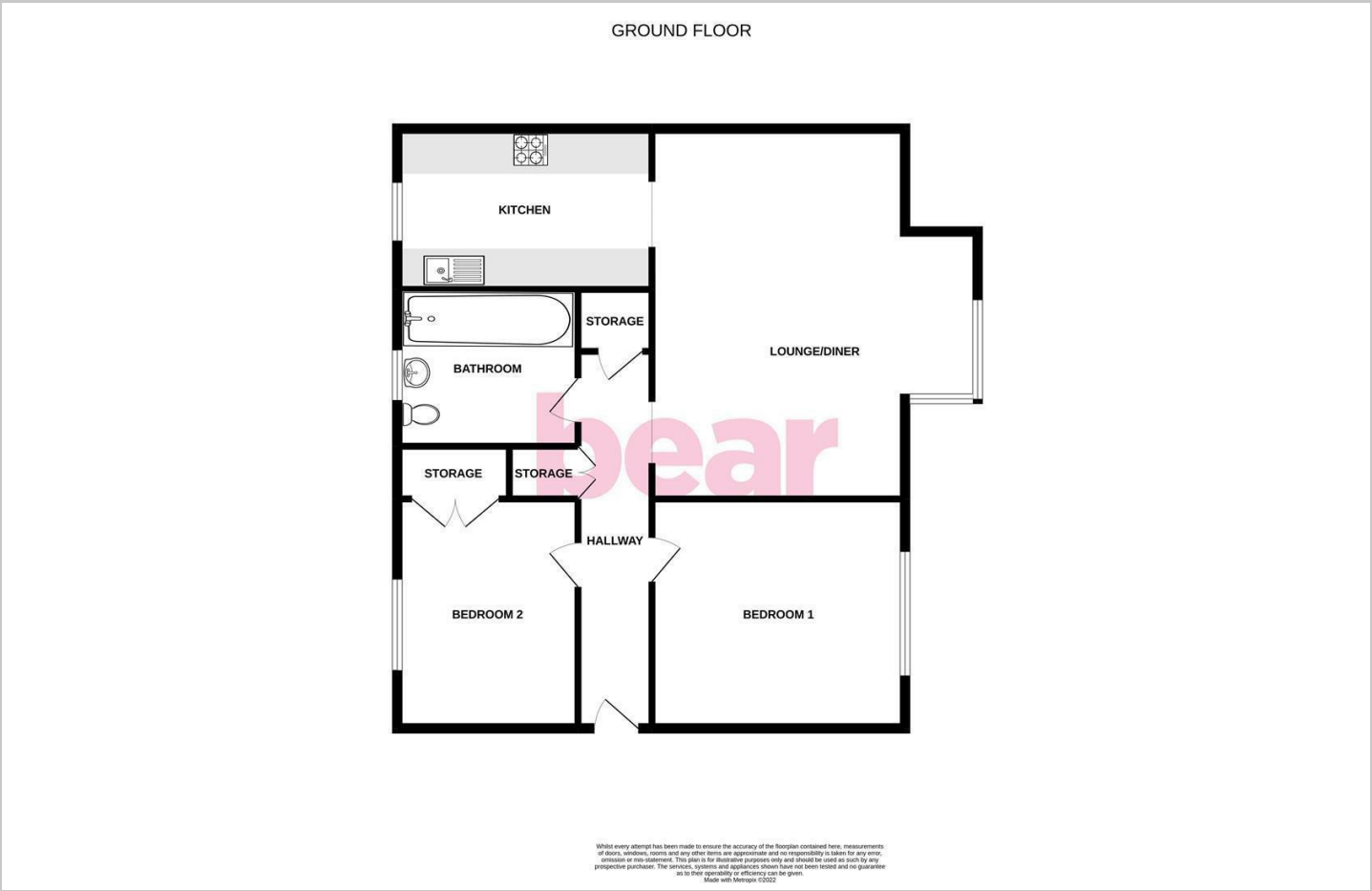

Area Map

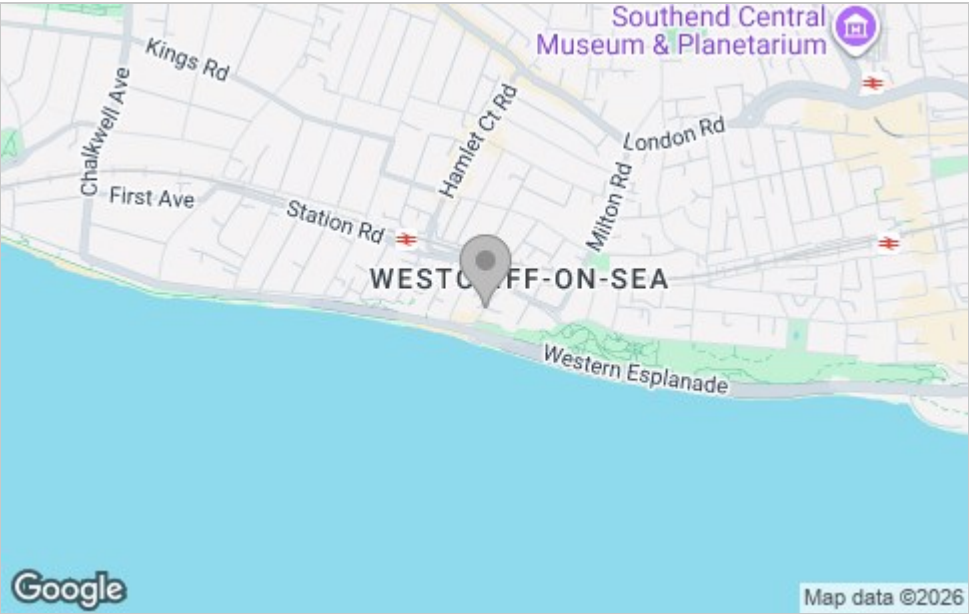

Viewing

Please contact our Southend-on-Sea Office on 01702 811211 if you wish to arrange a viewing appointment for this property or require further information.

Energy Efficiency Graph

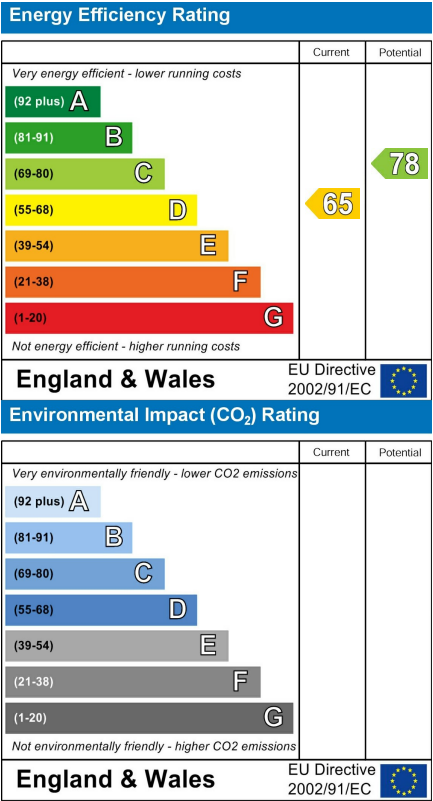

These particulars, whilst believed to be accurate are set out as a general outline only for guidance and do not constitute any part of an offer or contract. Intending purchasers should not rely on them as statements of representation of fact, but must satisfy themselves by inspection or otherwise as to their accuracy. No person in this firms employment has the authority to make or give any representation or warranty in respect of the property.

204 Woodgrange Drive, Southend-on-Sea, Essex, SS1 2SJ

Office: 01702 811211 info@bearestateagents.co.uk <https://www.bearestateagents.co.uk>